

**CITY OF
BEAVERTON**

Public Works Department
Engineering Division
Transportation Section

4755 S.W. Griffith Drive
P.O. Box 4755
Beaverton, Or 97076

Ph: 503-526-2269
Fx: 503-350-4052



1" = 50'

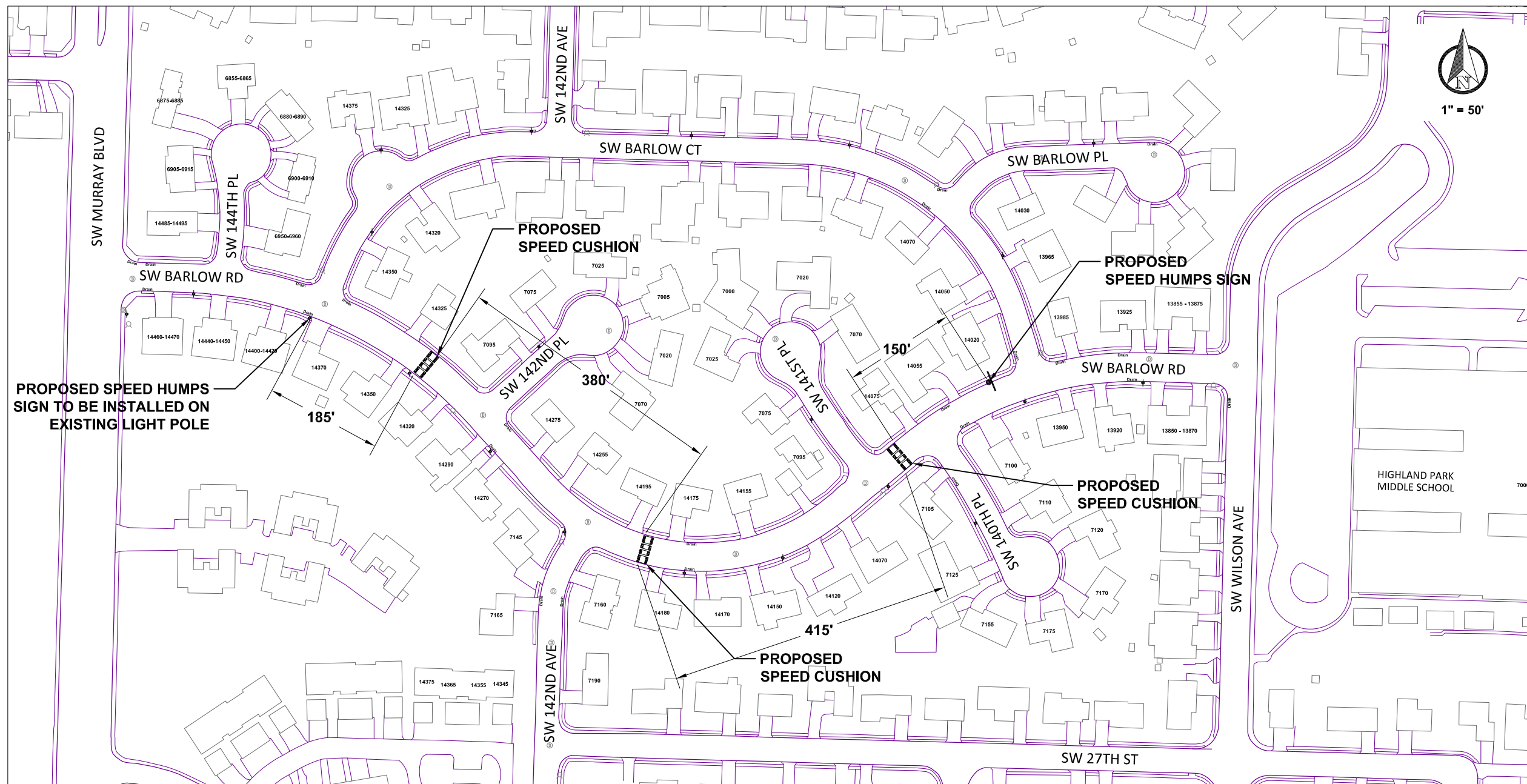

PROPOSED SPEED HUMPS
SIGN TO BE INSTALLED ON
EXISTING LIGHT POLE



30"x30"
NEXT
1/2 MILE
24"x18"

"SPEED HUMPS" SIGN - DETAIL
Not to Scale

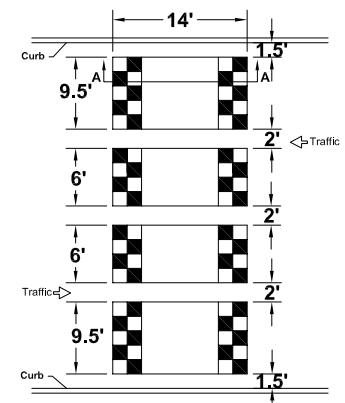

SECTION VIEW A - A
SPEED CUSHION DETAIL
40' STREET WIDTH
Not to Scale

LEGEND

- Drain
- Stormdrain
- Fire Hydrant
- Manhole
- Power Pole/
Luminaire

**SW BARLOW ROAD
TRAFFIC CALMING
OPTION A**

DESIGNED BY: TC
DRAWN BY: GO
CHECKED BY: TC
APPROVED BY: TC
PROJECT NO:
DATE: 3/5/2020